

Mark	Rev.	Date	Rev. by	Appr.
B	Drawing updated	29.8.06	HS	HS

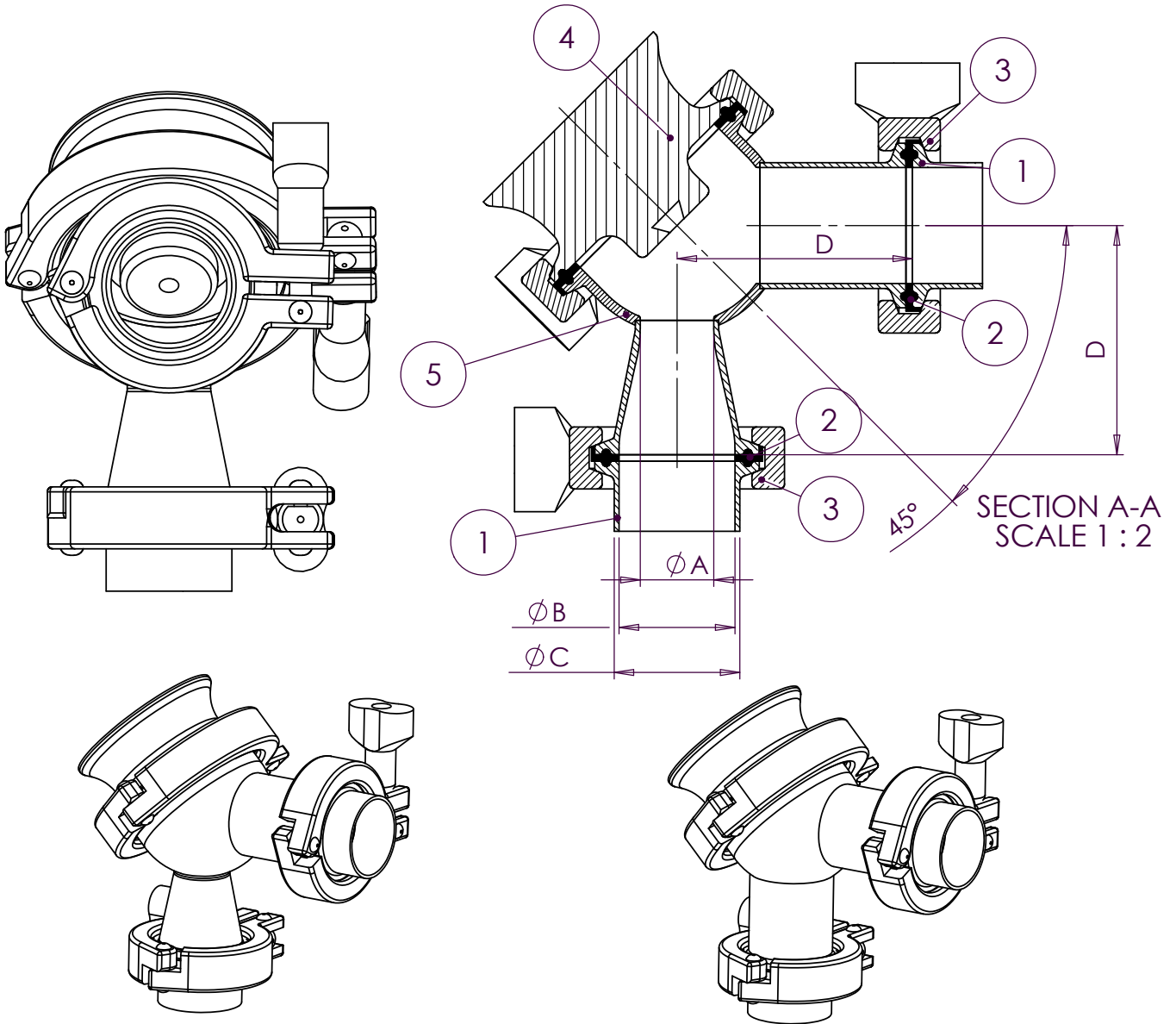

AFC-HSS-H15-RI

AFC-HSS-H10/H15-SI

Flow cell type	A	B	C	D
AFC-H10-SI	22.6 [0.890]	22.6 [0.890]	25.6 [1.008]	50.8 [2]
AFC-H15-RI	22.6 [0.890]	35.6 [1.402]	38.6 [1.520]	70.3 [2.768]
AFC-H15-SI	35.6 [1.402]	35.6 [1.402]	38.6 [1.520]	70.3 [2.768]

Item No.	Description	Material	Supplied by	Qty/Pcs.
1	Sanitary ferrule 1"/1.5"	AISI316L	Customer	2
2	Sanitary gasket 1"/1.5"	EPDM	Customer	2
3	Sanitary clamp 1"/1.5"	AISI304	Customer	2
4	PR-03-A/PR-23-AC sensor		K-Patents	1
5	AFC-HSS-H10/H15-SI/RI Flow cell	AISI316L	K-Patents	1

General tolerances	Scale 1:2	Join	File MTG428.drw	Material AISI316L	
--------------------	--------------	------	--------------------	----------------------	--

Drawing description AFC-HSS-H10/H15-SI/RI	
Drawing number MTG428/B	Drawn 1.9.2004 HS Appr. 1.9.2004 HS

K-PATENTS
PROCESS INSTRUMENTS